



TAI-SAW TECHNOLOGY CO., LTD.

No. 3, Industrial 2nd Rd., Ping-Chen Industrial District,
Taoyuan, 324, Taiwan, R.O.C.

TEL: 886-3-4690038 FAX: 886-3-4697532

E-mail: tstsales@mail.taisaw.com Web: www.taisaw.com

Product Specifications Approval Sheet

Product Description: SAW Filter 169.2 MHz SMD 5.0X7.0 mm

TST Parts No.: TB0484A

Customer Parts No.: _____

Company: _____
Division: _____
Approved by : _____
Date: _____

Checked by: _____ Kazuma Lee *Kazuma Lee*

Approval by: _____ Andy Yu *Andy Yu*

Date: _____ 2018/3/24

1. Customer signed back is required before TST can proceed with sample build and receive orders.
2. Orders received without customer signed back will be regarded as agreement on the specifications.
3. Any specifications changes must be approved upon by both parties and a new revision of specifications shall be released to reflect the changes.



TAI-SAW TECHNOLOGY CO., LTD.

No. 3, Industrial 2nd Rd., Ping-Chen Industrial District,
Taoyuan, 324, Taiwan, R.O.C.

TEL: 886-3-4690038 FAX: 886-3-4697532

E-mail: tstsales@mail.taisaw.com Web: www.taisaw.com

SAW Filter 169.2MHz

MODEL NO.:TB0484A

REV. NO.:2

A. MAXIMUM RATING:

1. Input Power Level: 15 dBm
2. DC Voltage : 5V
3. Operating Temperature: -40°C to +85°C
4. Storage Temperature: -50°C to +95°C

RoHS Compliant
Lead free
Lead-free soldering

B. ELECTRICAL CHARACTERISTICS:

Item	Unit	Min.	Type.	Max.	Note
Center frequency Fc	MHz	-	169.2	-	-
Insertion loss at center frequency ILc	dB	-	3.0	7.0	-
Ripple (169.19625~169.20375)	dB	-	±0.2	±1	-
Attenuation (relative to ILc)					
168.2 ~ 168.3025 MHz	dB	30	50	-	-
168.3025 ~ 169.1 MHz	dB	7	21	-	-
169.3 ~ 170.0975 MHz	dB	7	21	-	-
170.0975 ~ 170.2 MHz	dB	30	50	-	-
Temperature coefficient of frequency TCf		-0.034 ppm/C ²			

Note1. Considering -21 KHz frequency shift from -40°C to +85°C

C.OUTLINE DRAWING:

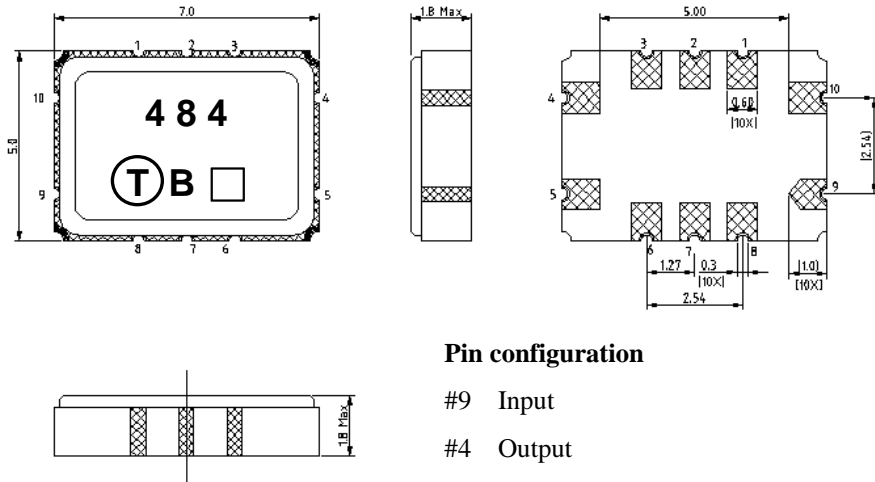

Pin configuration

- #9 Input
- #4 Output
- #10 Balance input or input ground
- #5 Balance output or output ground
- #1,2,3,6,7,8 To be grounded
- Date code
- Unit mm

Product Year Code

Year	2001 2005	2002 2006	2003 2007	2004 2008
Product Code	B	b	<u>B</u>	<u>b</u>

D. MEASUREMENT CIRCUIT:

50 Ohm Test circuit (single-ended / single-ended)

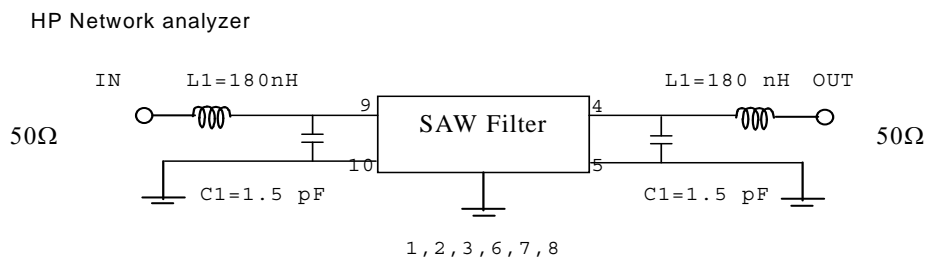

E. PCB Footprint:

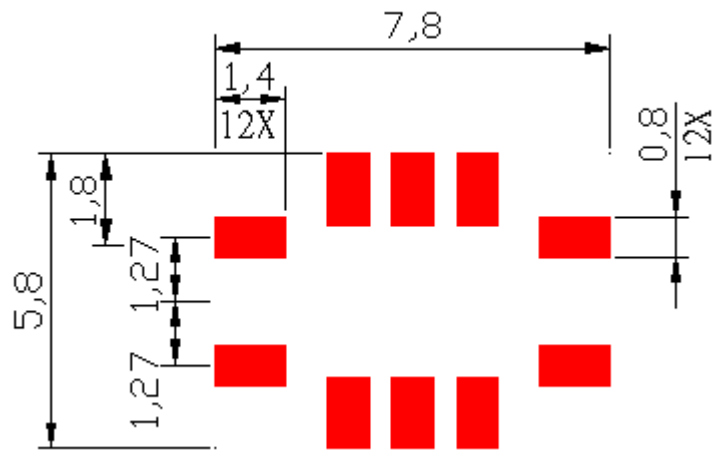

F. Frequency Characteristics :

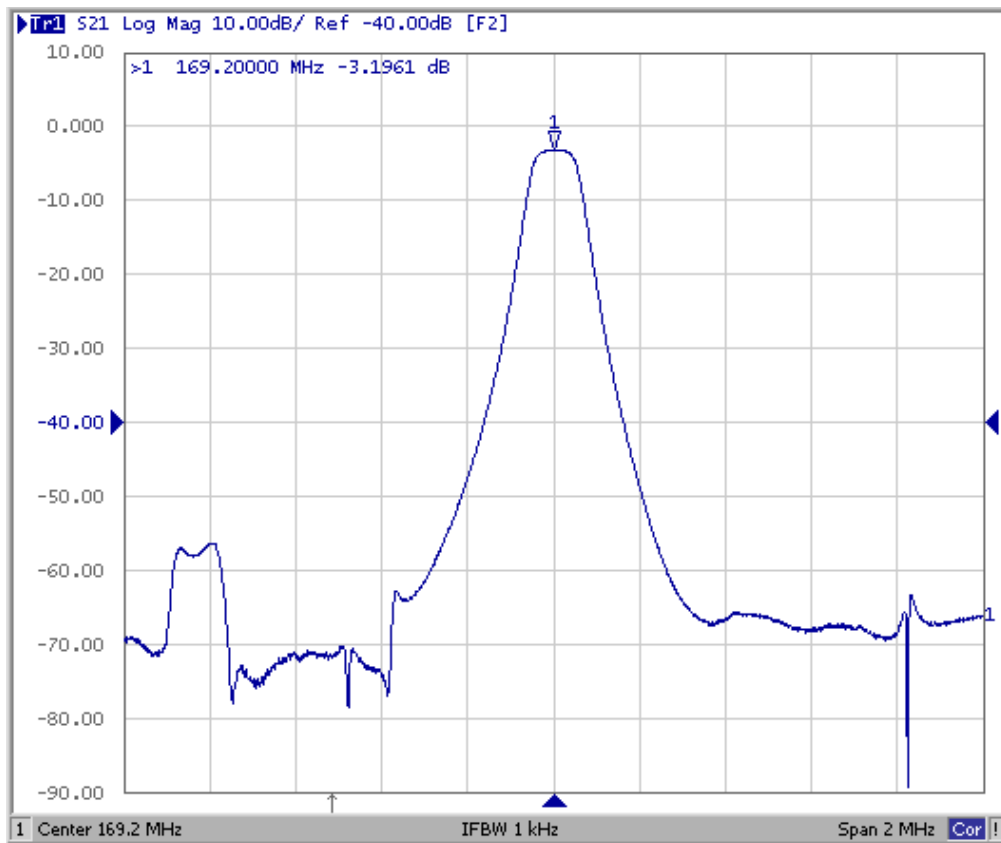
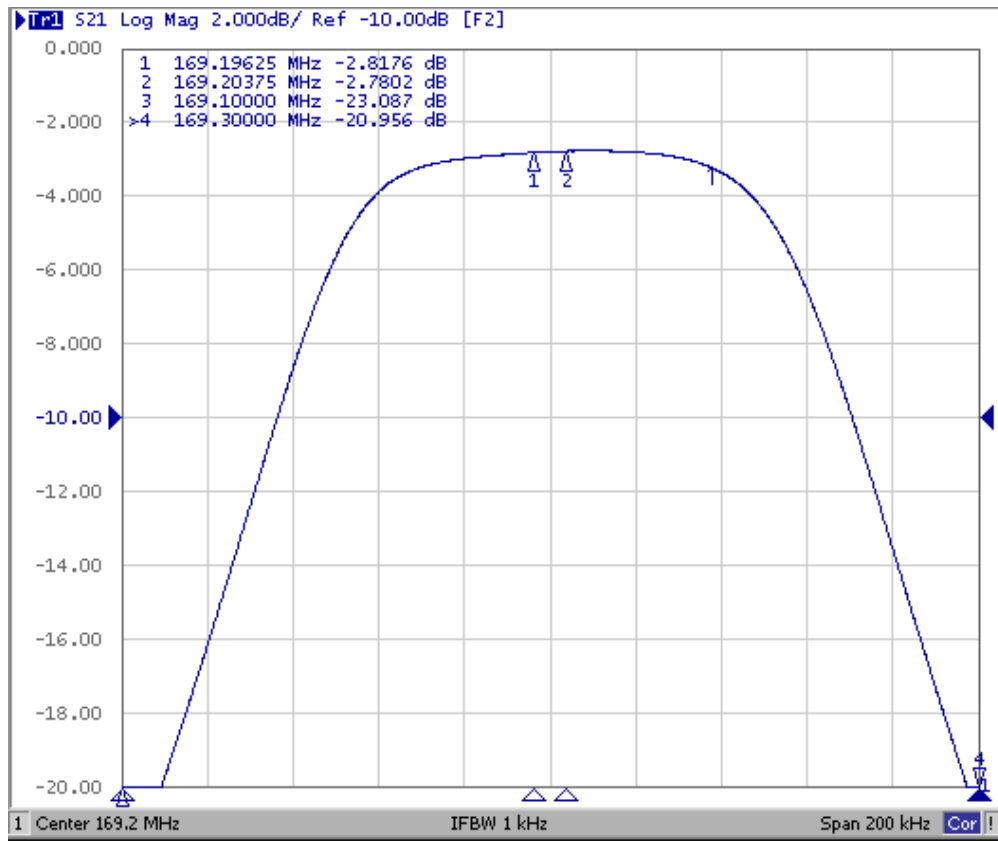

G. PACKING:
 1. REEL DIMENSION

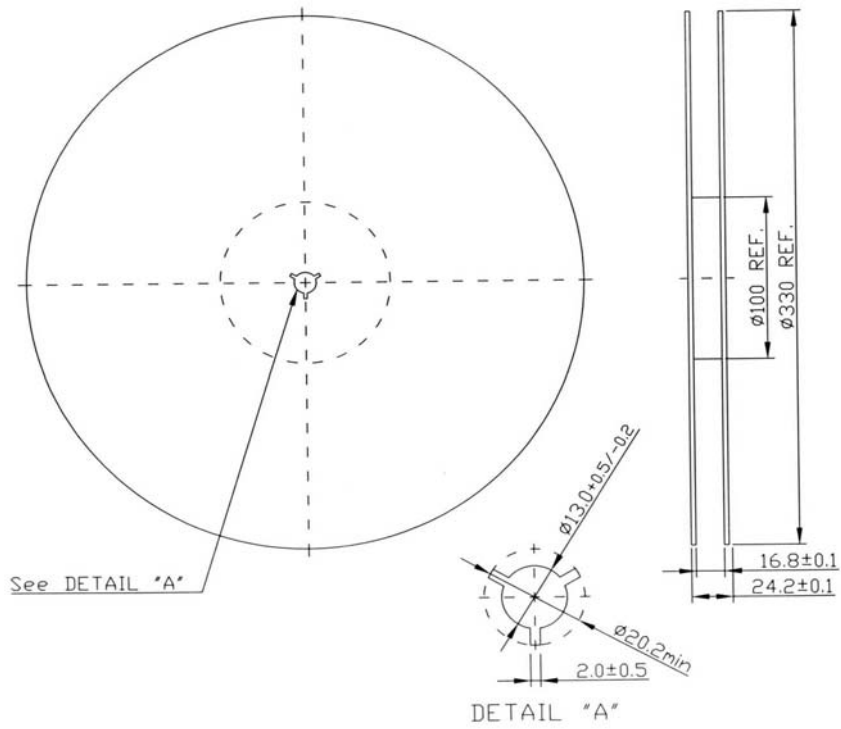

2. TAPE DIMENSION

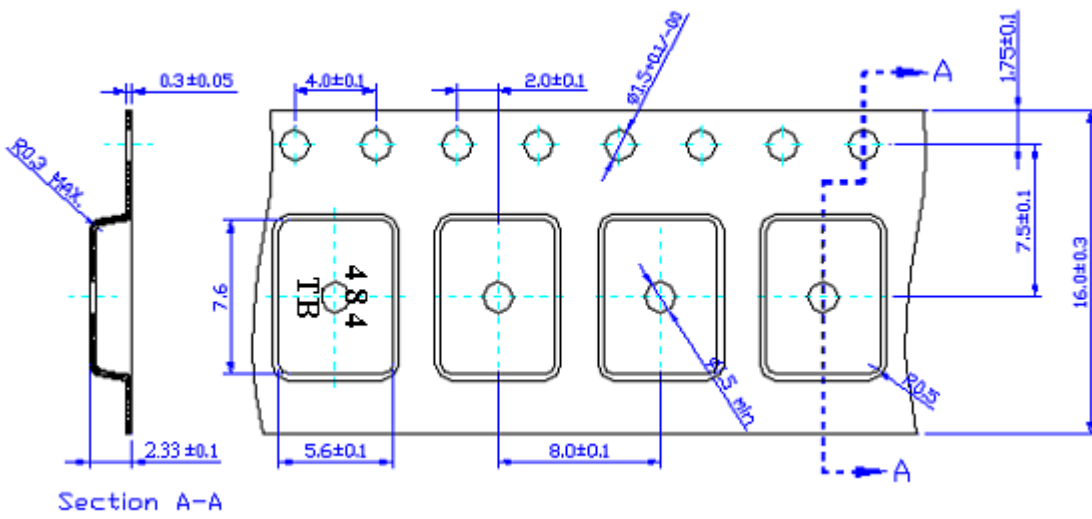

H. RECOMMENDED REFLOW PROFILE :

